

**TITLE :**  
**Plateau Rooflight**  
 > A roof window range suitable for pitched roofs between 10° and 20°  
**Ventilated Warm Roof with Ventilated Kerb  
 Lead Sheet Installation Detail**

DWG NO. PL\_WRLD\_VK\_10-20\_A SHEET NO. : 1 OF 2 REVISION:  
 SCALE : 1:5 @ A3 DO NOT SCALE DATE : 06/03/2014  
 This is a suggested installation detail which may not be exactly applicable to all situations and constructions. It is not a detailed or constructional proposal. Installers and designers are advised to check their own details for compliance with all currently applicable Local Authority by-laws, Acts of Parliament and British / ISO standards.

**A**  
 DB: EH  
 CB: PD

**the Rooflight Company**  
*The Professionals' Choice*

All information contained within this drawing is copyright © and design right of the Rooflight Company. The intellectual property rights of the products detailed within this drawing and embedded 3D models are owned by the Rooflight Company.  
 w: www.therooflightcompany.co.uk t: 01993 833 108 e: info@therooflightcompany.co.uk



**Key:**

- 1.** The Plateau Rooflight, with Manual Opening Option **1b** fixed to structural kerb **2c** using coach bolts fixed through fixing lugs **1c** around the perimeter of the roof window.
- 2.** Structural rafter support at jamb and structural trimmer support at head and cill
- 2b.** Structural kerb upstand **2c** to be a minimum of 150mm high. Ironmongery supportive packer **2d** at the cill, fitted around the fixing lugs.
- 3.** Batten Bearer to provide support for the roof deck.
- 4.** WBP Plywood roof deck.
- 5.** Insulation fitted above structural supports and around the perimeter of the kerb upstand **5b**.
- 6.** Timber reveal to align with the roof window linings **1d** to provide 'frameless' internal appearance. If the roof window linings are not already factory painted, **1d** MUST BE PAINTED with a timber finishing paint once the roof window is installed to ensure longevity of this component.
- 7.** Plasterboard lining with plasterboard stop **7b** to protect the corner. Plasterboard fitted behind the thermoliner of the roof window **1e**.
- 8.** Plaster skim.
- 9.** Softwood roofing battens. Battens **9b** clad the perimeter of the kerb upstand, with sufficient breaks along the lengths to provide ventilation for the roof cavity. (hidden for clarity)
- 10.** Underlay.
- 11.** Structural boards installed above insulation and around the perimeter of the kerb upstand **11b**.
- 12.** Softwood counter batten to provide support for roofing battens. Ensure there is unobstructed ventilation through the roof structure and up the kerb upstand. (hidden for clarity)
- 13.** Minimum 60mm raised section at the head of the rooflight to deflect the water away for the head of the rooflight.
- 14.** Lead sheet roofing. Rolls **14b** to run with the angle of Roof pitch. The rolls must be spaced 300mm apart and abut the kerb at the cill. Head rolls **14c** to be splayed at least 150mm from the kerb upstand to allow water to flow freely around the perimeter and prevent water pooling. Run the main sheet up the kerb upstand and create a lap with a secondary formed piece **14d** to 'cap' the top of the plywood **11b**, and insect mesh **16**.
- 15.** WBP plywood packers.
- 16.** Insect mesh to protect the ventilated cavity. Lap this under the lead cap **14b** and plywood rooflight packers **15**.
- 17.** Vapour barrier (Blue)
- 18.** Perimeter silicone seal. Seal perimeter of roof window **1** JUST PRIOR TO installation, using a thick continuous bead of low modulus neutral cure silicone sealant.
- 19.** Ply packer fitted to structural rafter supports **2** & **2c**.

**Please Note:**

These sectional details are provided as an installation suggestion. Due to the differing nature of installations we strongly advise you to consult 'Rolled Lead Sheet - The Complete Manual' published by The Lead Sheet Association ([www.leadsheet.co.uk](http://www.leadsheet.co.uk)) and your roof window installer to verify fitness for purpose. This drawing does not constitute a structural proposal. Sufficiency of structural supports to be checked by roof window purchaser's structural consultant.

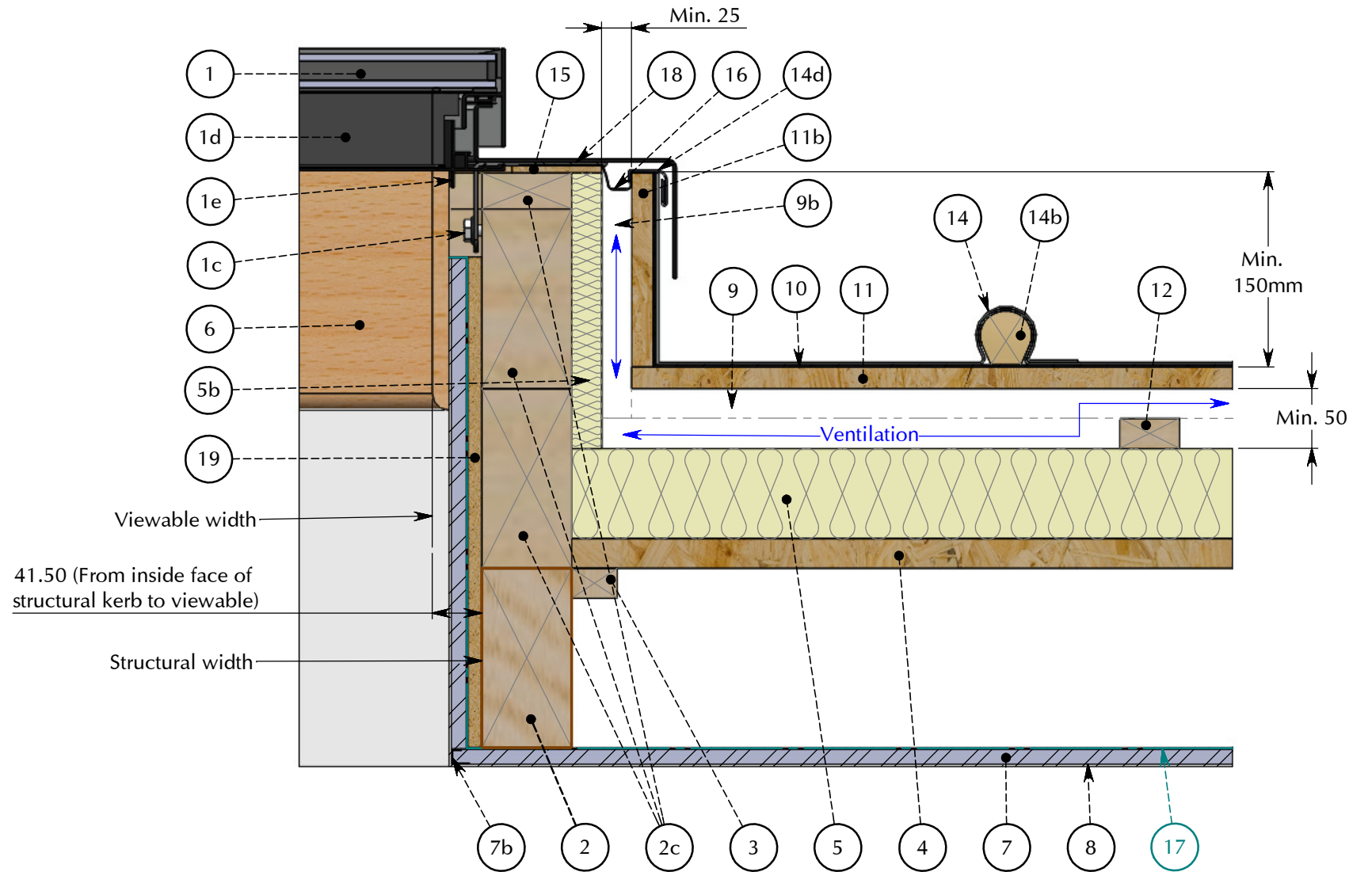

**TITLE :**  
**Plateau Rooflight**  
 > A roof window range suitable for pitched roofs between 10° and 20°  
**Ventilated Warm Roof with Ventilated Kerb Lead Sheet Installation Detail**

DWG NO. : PL\_WRLD\_VK\_10-20\_A  
 SHEET NO. : 2 OF 2  
 SCALE : 1:5 @ A3  
 DO NOT SCALE  
 DATE : 06/03/2014  
 This is a suggested installation detail which may not be exactly applicable to all situations and constructions. It is not a detailed or constructional proposal. Installers and designers are advised to check their own details for compliance with all currently applicable Local Authority by-laws, Acts of Parliament and British / ISO standards.

REVISION:  
  
 The Lead Sheet Association  
 These details have been drawn up in collaboration with The Lead Sheet Association - any installation undertaken must be in accordance with the LSA manual - for more details visit [www.leadsheet.co.uk](http://www.leadsheet.co.uk)  
 A  
 DB: EH  
 CB: PD

  
 the Rooflight Company  
 The Professionals' Choice  
 All information contained within this drawing is copyright © and design right of the Rooflight Company. The intellectual property rights of the products detailed within this drawing and embedded 3D models are owned by the Rooflight Company.  
 w: [www.therooflightcompany.co.uk](http://www.therooflightcompany.co.uk) t: 01993 833 108 e: [info@therooflightcompany.co.uk](mailto:info@therooflightcompany.co.uk)  
