

Technical Data Sheet

The Flashing Kit - On the Rafter Variant

Product Description

The Flashing Kit is designed to be used with all 'On the Rafter' pitched window installations and is suited to almost all types of roof tile or slate. It is supplied with flashing at the head and cill, together with a single continuous uPVC soaker at each jamb, designed to be cut at predefined heights to match the finished roof line. Providing that your roof build-up remains below 75mm, your installation will be suitable for a flashing kit.

Installation

Suitable for 'On the Rafter' pitched roof installations only.

Can be installed into almost all types of roof tile and slate, providing that your roof build-up remains below 75mm. This is measured from the top of the structural support to the top of the uPVC jamb flashing (as shown).

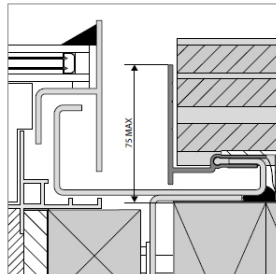

The Flashing Kit Installation Manual and installation drawings are available to download from our website.

Size

Standard Products

Suitable for Conservation and neo Rooflights.

Bespoke Products

Special sizes not available.

Leadtime

Subject to availability. The usual lead time is 5 working day.



Flashing Kits

Jamb Flashing

The Flashing Kit jamb flashings comprise of a uPVC extrusion, in RAL 7022 Umbra Grey, with a Type HR Roof Underlay roofing membrane and weather foam strip made from Polyether Foam.

Flashings

Code 4 lead is supplied for the cill flashing and soakers. The head flashing is a lead-free waterproof flashing material which is manufactured from aluminium mesh coated in a mixture of modified bitumen and additives.

Roofing Membrane

The Flashing Kit includes a Type HR Roof Underlay which is installed at the head and jambs of the rooflight.

Warranty

Our Flashing Kits are guaranteed for 12 months in accordance with our Terms and Conditions.