

DO NOT SCALE. IF IN DOUBT ASK. ALL DIMENSIONS IN MILLIMETERS UNLESS STATED OTHERWISE.

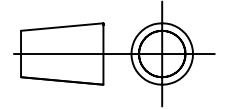

Note: With this detail the top of the casement finishes above the level of the tiles. If a flush finish is required use our FLUSH SLATE detail proposal.

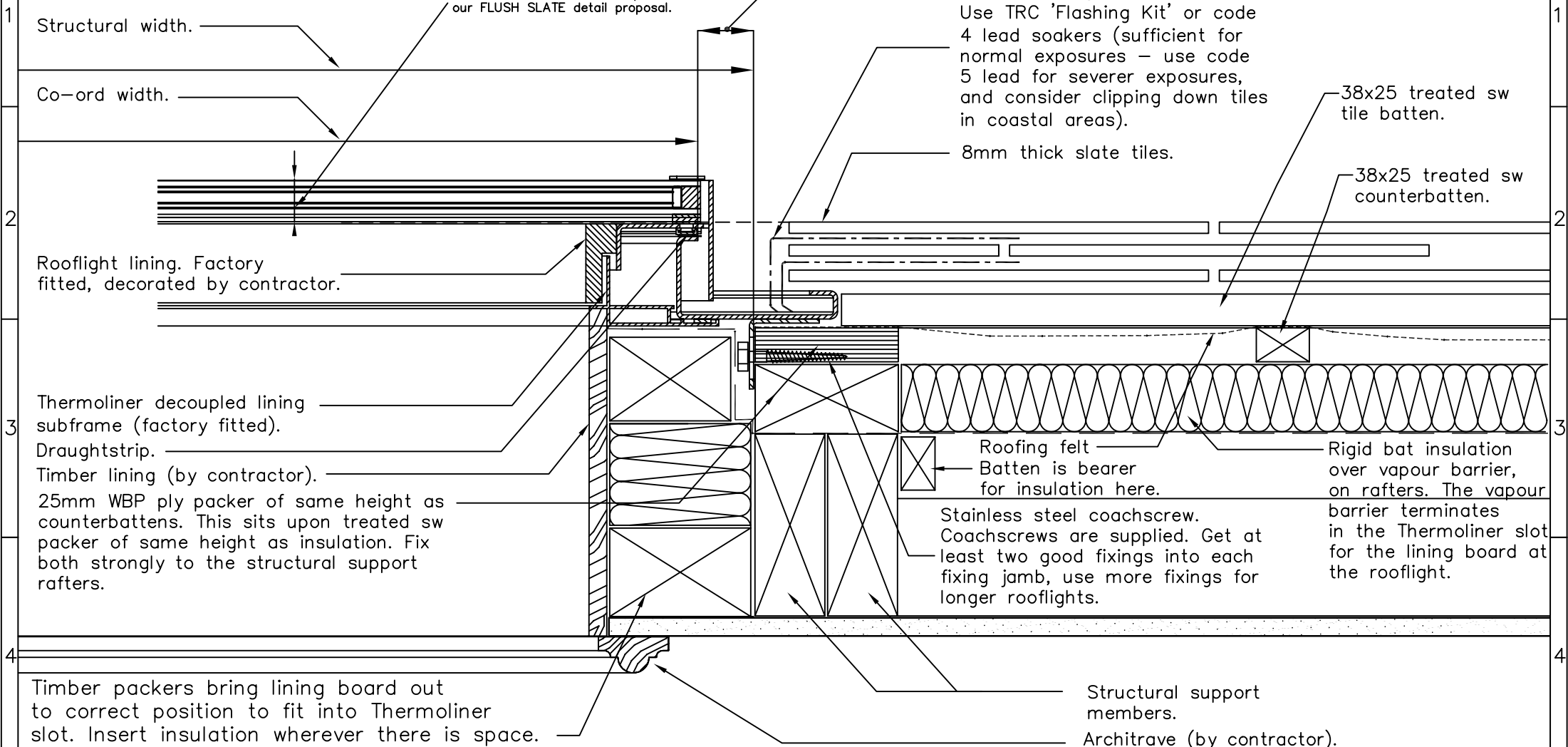

50mm.
Jamb Flashing.
Use TRC 'Flashing Kit' or code 4 lead soakers (sufficient for normal exposures – use code 5 lead for severer exposures, and consider clipping down tiles in coastal areas).
8mm thick slate tiles.

38x25 treated sw tile batten.
38x25 treated sw counterbatten.

Structural width.
Co-ord width.
Rooflight lining. Factory fitted, decorated by contractor.

Thermoliner decoupled lining subframe (factory fitted).
Draughtstrip.
Timber lining (by contractor).
25mm WBP ply packer of same height as counterbattens. This sits upon treated sw packer of same height as insulation. Fix both strongly to the structural support rafters.

Roofing felt
Batten is bearer for insulation here.
Stainless steel coachscrew. Coachscrews are supplied. Get at least two good fixings into each fixing jamb, use more fixings for longer rooflights.
Rigid bat insulation over vapour barrier, on rafters. The vapour barrier terminates in the Thermoliner slot for the lining board at the rooflight.

Timber packers bring lining board out to correct position to fit into Thermoliner slot. Insert insulation wherever there is space.
Structural support members.
Architrave (by contractor).

the Rooflight Company
Wychwood Busines Centre
Milton Road
Shipton-Under-Wychwood
Oxon OX7 6XU

Telephone: 01993-830-613
Fax: 01993-831-066
Email: info@therooflightcompany.co.uk

Please note that this drawing does not constitute a structural support proposal. Sufficiency of structural supports to be checked by rooflight purchaser's structural consultant.

Drawing Ref/No. 12386-12	
Title. WARM ROOF SLATE TILE JAMB DETAIL NEO-S ROOFLIGHT	
Scale. N.T.S	Date: 28/04/09
Drawn By: PD	
Checked By: TM	Revision No. B

The information contained within this drawing is Copyright & Design right of the Rooflight Company