

DO NOT SCALE. IF IN DOUBT ASK. ALL DIMENSIONS IN MILLIMETERS UNLESS STATED OTHERWISE.

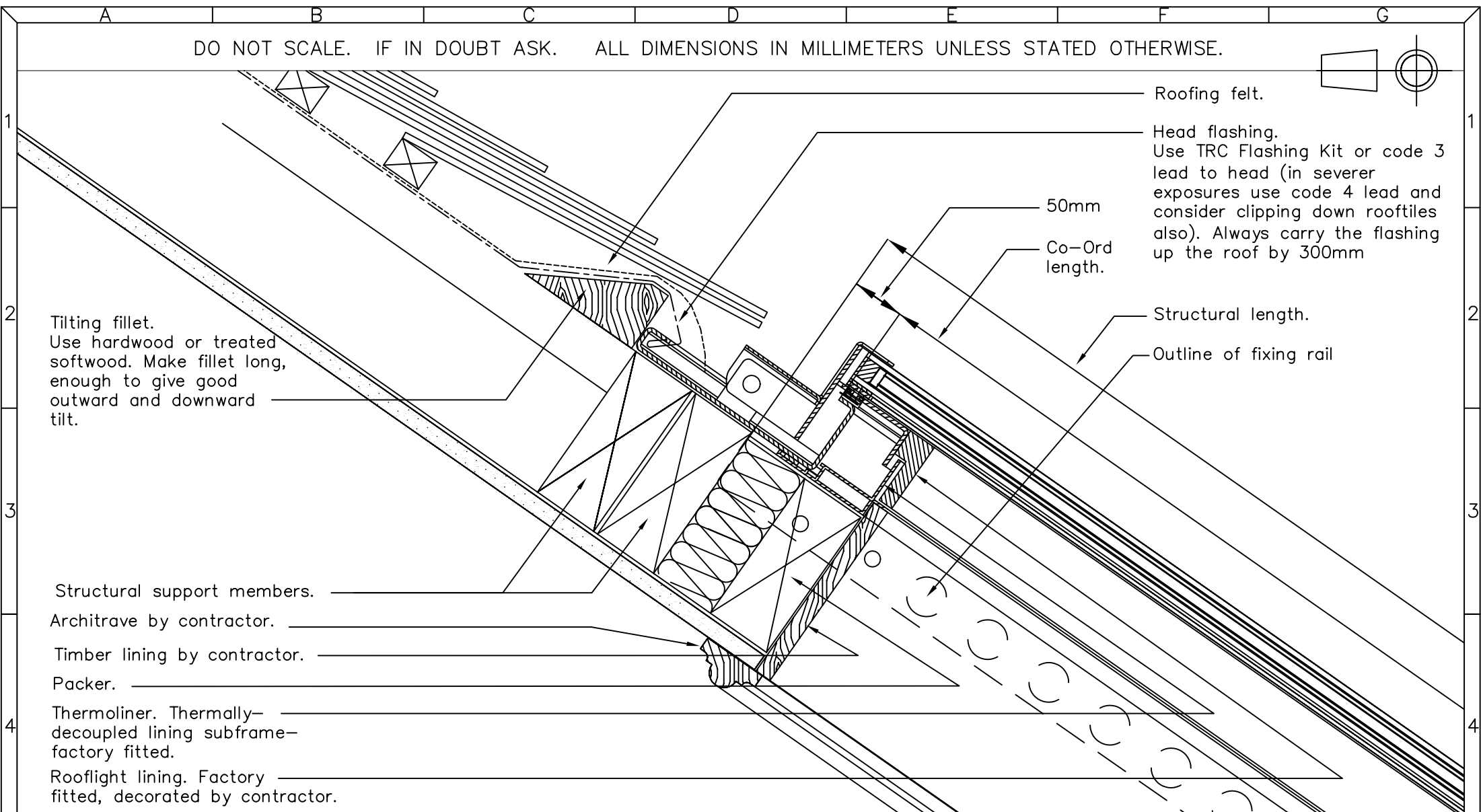
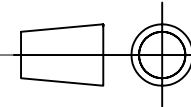

Tilting fillet.
Use hardwood or treated softwood. Make fillet long, enough to give good outward and downward tilt.

Roofing felt.
Head flashing.
Use TRC Flashing Kit or code 3 lead to head (in severer exposures use code 4 lead and consider clipping down rooftiles also). Always carry the flashing up the roof by 300mm

50mm
Co-Ord length.

Structural length.
Outline of fixing rail

Structural support members.
Architrave by contractor.
Timber lining by contractor.
Packer.
Thermoliner. Thermally-decoupled lining subframe-factory fitted.
Rooflight lining. Factory fitted, decorated by contractor.

the Rooflight Company
Wychwood Busines Centre
Milton Road
Shipton-Under-Wychwood
Oxon OX7 6XU

Telephone: 01993-830-613
Fax: 01993-831-066
Email: info@therooflightcompany.co.uk

Please note that this drawing does not constitute a structural support proposal. Sufficiency of structural supports to be checked by rooflight purchaser's structural consultant.

Drawing Ref/No. 12386-04

Title. SLATE TILE HEAD DETAIL
NEO-S ROOFLIGHT

Scale. N.T.S Date:28/04/09

Drawn By:PD

Checked By:TM Revision No. B

The information contained within this drawing is Copyright & Design right of the Rooflight Company