

DO NOT SCALE. IF IN DOUBT ASK. ALL DIMENSIONS IN MILLIMETERS UNLESS STATED OTHERWISE.

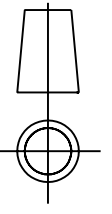

Carry lead head flashing 300mm up the roof.

Mastic seal.
Apply a thick continuous bead of low modulus neutral cure silicone along the top of the rooflight edge rollover in a position where it will be covered by the shaped hardwood head member. Apply the silicone just prior to fitting the head member in position.

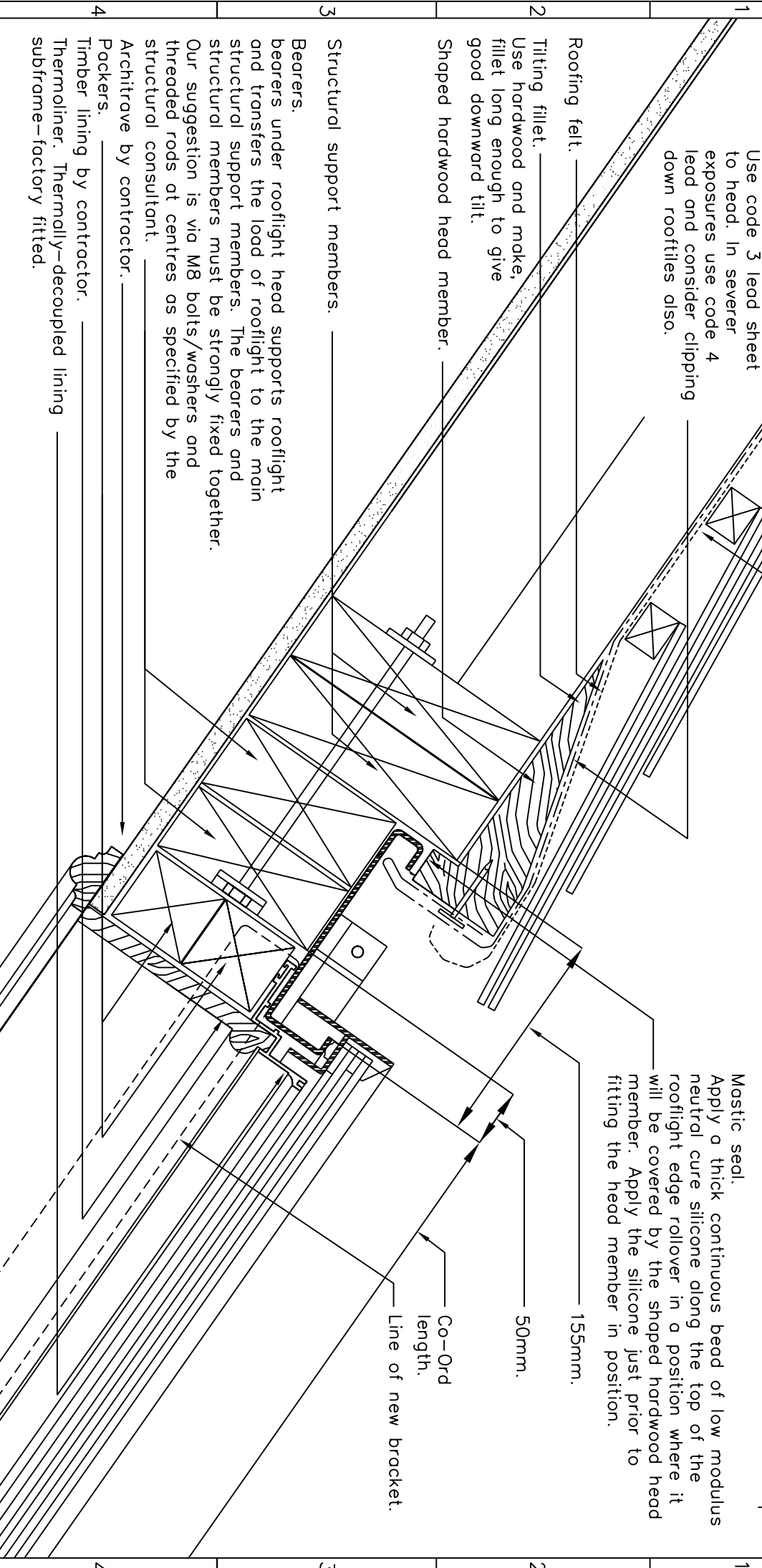

The Metal Window Company Limited
Unit 8, Wychwood Business Centre
Milton Road
Shipton—Under—Wychwood
Oxon OX7 6XU

Telephone: 01993—830—613
Fax: 01993—831—066
Email: info@metalwindow.co.uk

The information contained within this drawing is Copyright & Design right of THE METAL WINDOW COMPANY LIMITED.

Please note that this drawing does not constitute a structural support proposal. Sufficiency of structural supports to be checked by rooflight purchaser's structural consultant.

Drawing Ref/No. 11060—30

Title: FLUSH SLATE HEAD DETAIL FOR TOP HUNG ROOFLIGHTS

Scale: N.T.S Date:16/01/02

Drawn By:JLM

Checked By:JLM

Revision No.

DO NOT SCALE. IF IN DOUBT ASK. ALL DIMENSIONS IN MILLIMETERS UNLESS STATED OTHERWISE.

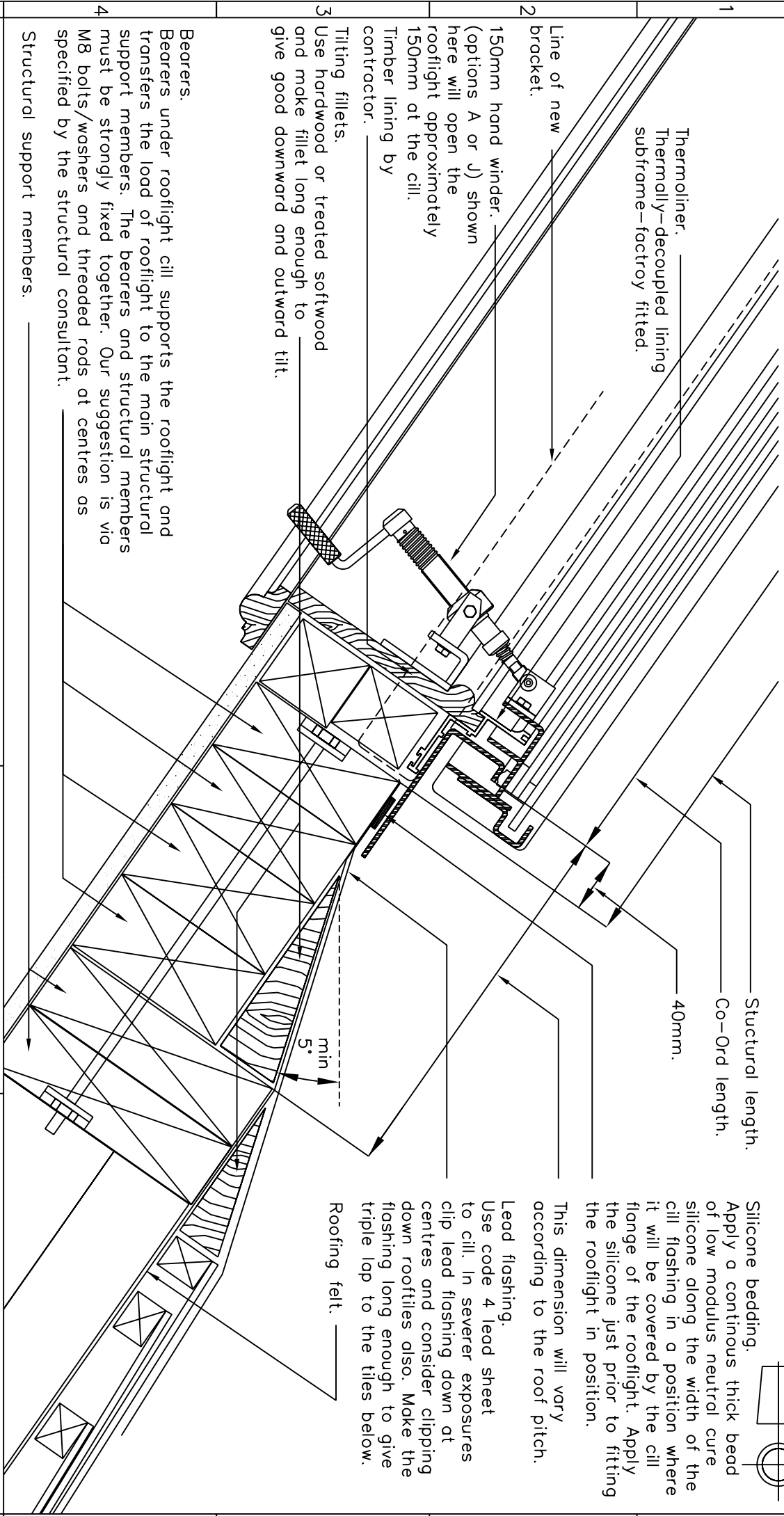

Bearers.
Bearers under rooflight cill supports the rooflight and transfers the load of rooflight to the main structural support members. The bearers and structural members must be strongly fixed together. Our suggestion is via M8 bolts/washers and threaded rods at centres as specified by the structural consultant.

Structural support members.

The Metal Window Company Limited
Unit 8, Wychwood Business Centre
Milton Road
Shipton—Under—Wychwood
Oxon OX7 6XU

Telephone: 01993—830—613
Fax: 01993—831—066
Email: info@metalwindow.co.uk

The information contained within this drawing is Copyright & Design right of THE METAL WINDOW COMPANY LIMITED.

Please note that this drawing does not constitute a structural support proposal. Sufficiency of structural supports to be checked by rooflight purchaser's structural consultant.

Drawing Ref/No. 11061—33	
Title: FLUSH SLATE CILL DETAIL FOR TOP HUNG ROOFLIGHTS	
Scale: N.T.S	Date: 16/01/02
Drawn By: JIM	Revision No.
Checked By: JIM	

DO NOT SCALE. IF IN DOUBT ASK. ALL DIMENSIONS IN MILLIMETERS UNLESS STATED OTHERWISE.

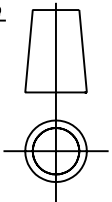

lead Sockers.
Code 3 lead is sufficient for normal exposures. Use code 4 or code 5 lead for severer exposures, and consider clipping down in coastal areas.

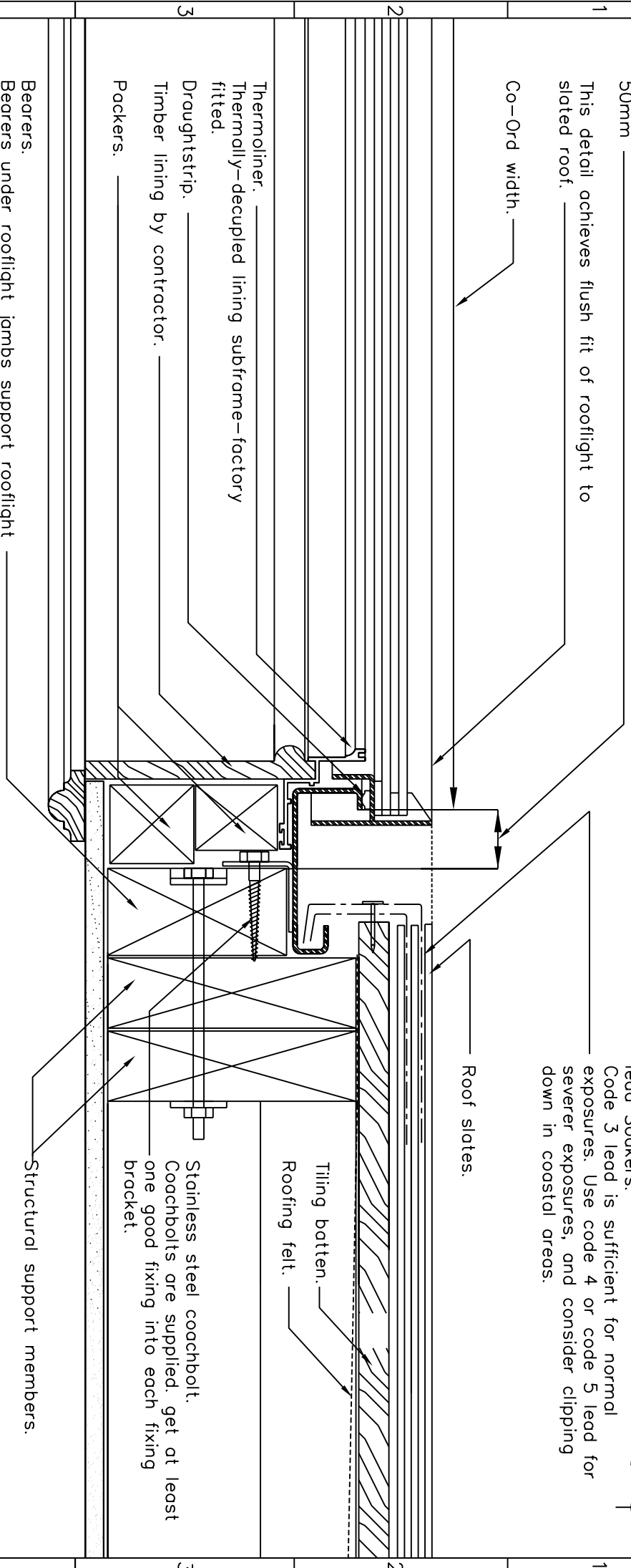

5
The Metal Window Company Limited
Unit 8, Wychwood Business Centre
Milton Road
Shipton-Under-Wychwood
Oxon OX7 6XU

Telephone: 01993-830-613
Fax: 01993-831-066
Email: info@metalwindow.co.uk

The information contained within this drawing is Copyright & Design right of THE METAL WINDOW COMPANY LIMITED.

Please note that this drawing does not constitute a structural support proposal. Sufficiency of structural supports to be checked by rooflight purchaser's structural consultant.

Drawing Ref/No. 11062-34

Title: FLUSH SLATE JAMB DETAIL
FOR TOP HUNG ROOFLIGHTS

Scale: N.T.S Date:16/01/02

Drawn By:JM

Checked By:JM

Revision No.