

DO NOT SCALE. IF IN DOUBT ASK. ALL DIMENSIONS IN MILLIMETERS UNLESS STATED OTHERWISE.

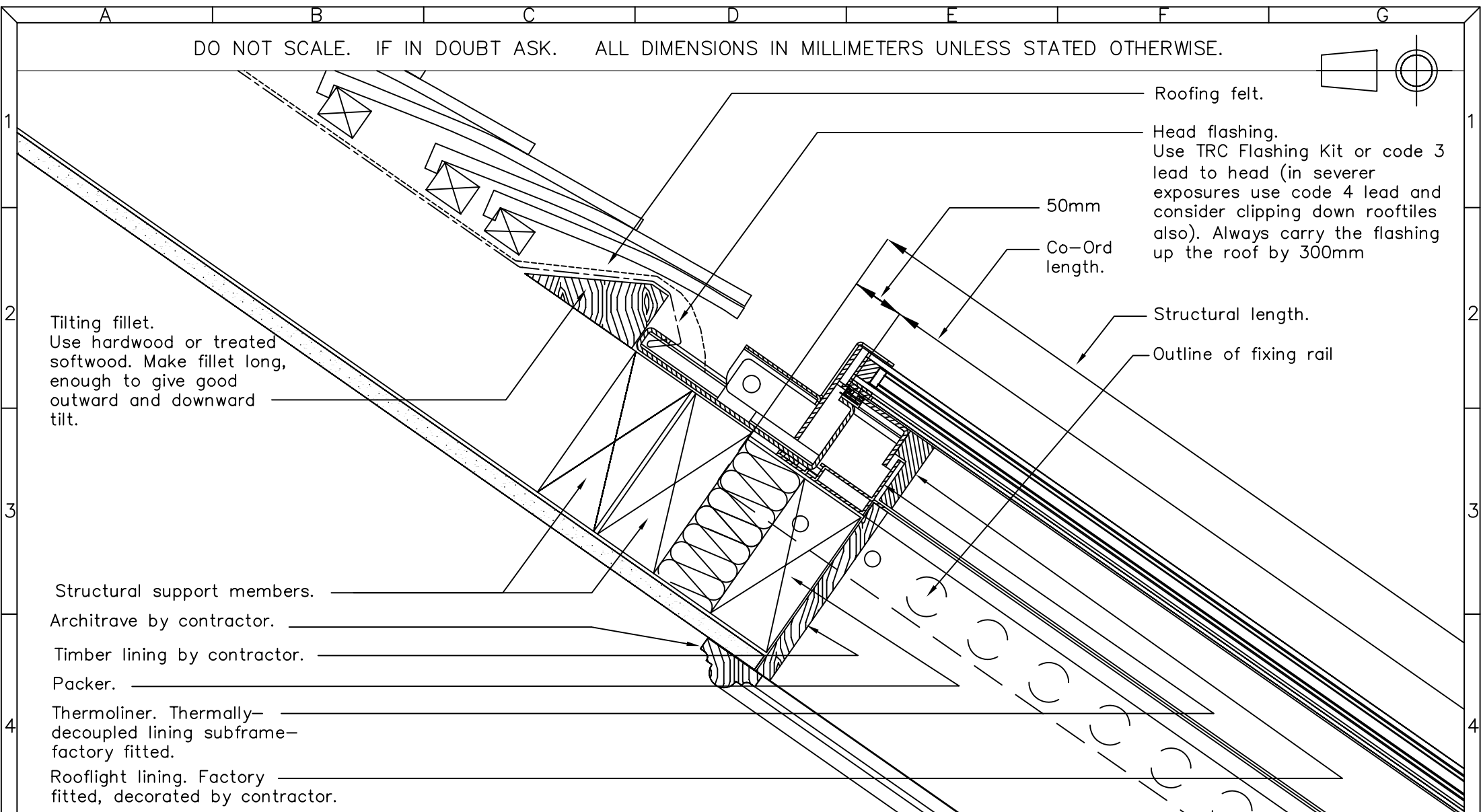
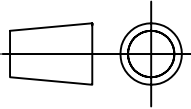

Roofing felt.
 Head flashing.
 Use TRC Flashing Kit or code 3 lead to head (in severer exposures use code 4 lead and consider clipping down rooftiles also). Always carry the flashing up the roof by 300mm

Tilting fillet.
 Use hardwood or treated softwood. Make fillet long, enough to give good outward and downward tilt.

Structural support members.
 Architrave by contractor.
 Timber lining by contractor.
 Packer.
 Thermoliner. Thermally-decoupled lining subframe-factory fitted.
 Rooflight lining. Factory fitted, decorated by contractor.

50mm
 Co-Ord length.

Structural length.
 Outline of fixing rail

the Rooflight Company
 Wychwood Busines Centre
 Milton Road
 Shipton-Under-Wychwood
 Oxon OX7 6XU

Telephone: 01993-830-613
 Fax: 01993-831-066
 Email: info@therooflightcompany.co.uk

Please note that this drawing does not constitute a structural support proposal. Sufficiency of structural supports to be checked by rooflight purchaser's structural consultant.

Drawing Ref/No. 12386-01

Title. CLAY TILE HEAD DETAIL
 NEO-S ROOFLIGHT

Scale. N.T.S Date:28/04/09

Drawn By:PD

Checked By:TM Revision No. B

The information contained within this drawing is Copyright & Design right of the Rooflight Company