

DO NOT SCALE. IF IN DOUBT ASK. ALL DIMENSIONS IN MILLIMETERS UNLESS STATED OTHERWISE.

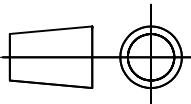

38x25 batten.

38x25 counterbatten.

Vapour barrier under insulation is carried through to rooflight and terminates in Thermoliner slot for lining.

Rigid bat insulation over vapour barrier, on rafters.

25mm WBP Ply packer of same height as counterbattens. This sits upon treated sw packer of same height as insulation. Fix both strongly to the head trimmers.

Tilting fillet.
Use hardwood or treated softwood. Make fillet long, enough to give good outward and downward tilt.

Structural support members.

Timber lining (by contractor).

Architrave (by contractor).

Timber packers bring lining board out to correct position to fit into Thermoliner slot. Insert insulation wherever there is space.

Thermoliner decoupled lining subframe (factory fitted).

Roofing felt.

Head flashing.

Use TRC Flashing Kit or code 3 lead to head (in severer exposures use code 4 lead and consider clipping down rooftiles also). Always carry the flashing up the roof by 300mm

Clay rooftile

eaves tile course

50mm

Rooflight lining. Factory fitted, decorated by contractor.

Structural length.

Co-Ord length.

Outline of fixing rail.

the Rooflight Company
Wychwood Busines Centre
Milton Road
Shipton-Under-Wychwood
Oxon OX7 6XU

Telephone: 01993-830-613
Fax: 01993-831-066
Email: info@therooflightcompany.co.uk

Please note that this drawing does not constitute a structural support proposal. Sufficiency of structural supports to be checked by rooflight purchaser's structural consultant.

Drawing Ref/No. 12386-07

Title. WARM ROOF CLAY TILE HEAD
DETAIL NEO-S ROOFLIGHT

Scale. N.T.S Date:28/04/09

Drawn By:PD

Checked By:TM

Revision No. B

The information contained within this drawing is Copyright & Design right of the Rooflight Company